

Front Caliper

Reassembly

CAUTION:

- Before reassembling, check that all parts are free of dust and other foreign particles.
- Replace parts with new ones whenever specified to do so.
- Use only clean DOT3 or 4 brake fluid.
- Make sure no dirt or other foreign matter is allowed to contaminate the brake fluid.
- Do not mix different brands of brake fluid as they may not be compatible.
- Do not spill brake fluid on the car; it may damage the paint, if brake fluid does contact the paint; wash it off immediately with water.

1. Clean the piston and caliper bore with brake fluid and inspect for wear or damage.
2. Apply silicone grease to new piston seal, then install the piston seal in the cylinder groove.
3. Apply silicone grease to new piston boot, then install the piston boot in the cylinder groove.

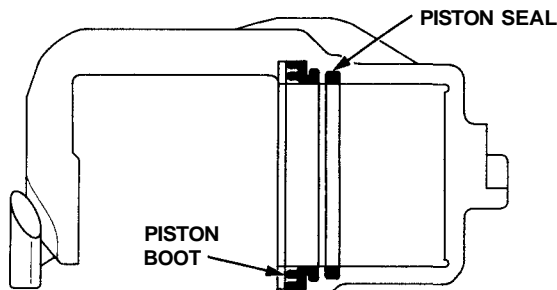

4. Lubricate the caliper cylinder and piston with brake fluid, then install the piston in the cylinder with the dished end facing in.

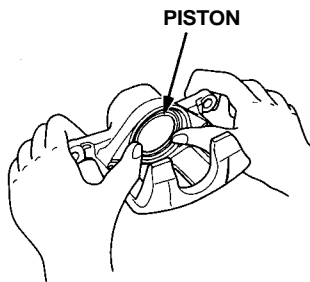

5. Reinstall the caliper in the reverse order of removal.

⚠ WARNING When reusing the brake pads, always reinstall the brake pads in their original positions to prevent loss of braking efficiency.

6. Fill the brake reservoir up and bleed the brake system (see page 19-11).

Front Brake Disc

Runout Inspection

1. Support the front of the car on safety stands and remove the front wheels.
2. Remove the front brake disc pads, (see page 19-7).
3. Inspect the disc surface for grooves, cracks, and rust. Clean the disc thoroughly and remove all rust.
4. Use suitable nuts (12 x 1.5 mm) and plain washers to hold the disc securely against the hub. Torque nuts to 110 N·m (11 kg·m, 80 lb·ft). Mount a dial indicator as shown.

Brake Disc Runout:

Service Limit: 0.10 mm (0.004 in)

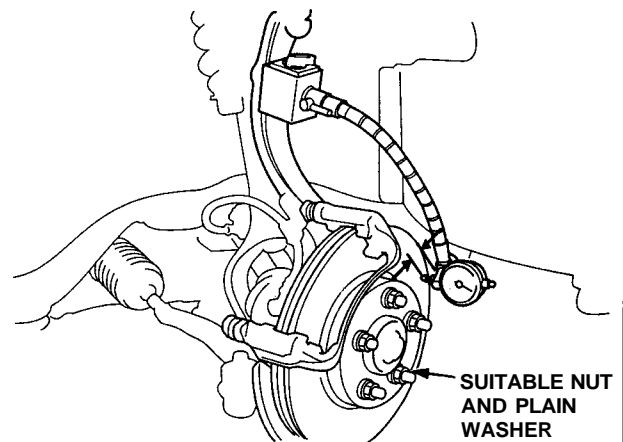

5. If the disc is beyond the service limit, refinish the disc with an on-car brake lathe. Be sure to install washers and nuts to hold disc securely to hub. Torque to 110 N·m (11 kg·m, 80 lb·ft). The Kwik-Lathe produced by Kwik-Way Manufacturing Co. and the "Front Wheel Drive Disc Brake Lathe" offered by Snap-on Tools Co. are approved for this operation.

Max. Refinishing Limit: 21.0 mm (0.83 in)

NOTE: A new disc should be refinished if its runout is greater than 0.10 mm (0.004 in).